

Pressure-Sensitive Edge Guards



The power of control. Automated.

Manufactured to meet the user's specification for length and outlet location, EGS110 and EGS120 when pressed, sends a signal to the safety controller to stop or reverse operation, depending on the application. Multiple mounting channel designs allow for easy installation on most surfaces.

Larco Edge Guards prevent injury at doorway or machinery pinch points. Use in any application where closure of the pinch point could cause injury or entrapment.



EGS110 TECHNICAL SPECIFICATIONS

Color	Black
Length	6 Inches to 100 ft.
Sensitivity	8 psi
Lead Wire	2ft. 22 Gauge - Standard
Wire Outlet Location	Specify Right Hand, Left Hand or End
Wiring	4 wire, Normally Open
Electrical Requirements	Maximum 24 Volts AC/DC, 1/2 Amp
Mounting Channel	High Density PVC
Sensing Edge	Flexible PVC
Temperature Range	-30°F to +155°F

CHANNEL DESIGN

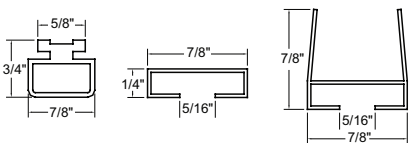

EGS110

CHANNEL DESIGN

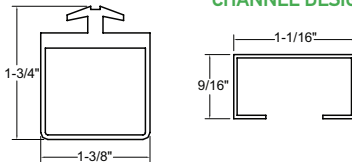

EGS120

EGS120 TECHNICAL SPECIFICATIONS

Color	Black
Length	6 Inches to 100 ft.
Sensitivity	4 psi - Approximately
Lead Wire	2 ft. 18 Gauge - Standard
Wire Outlet Location	Specify Right Hand, Left Hand, or End
Wiring	4-wire, Normally Open
Electrical Requirements	24 Volt AC/DC, 1/2 Amp
Mounting Channel	Aluminum
Sensing Edge	Flexible PVC
Temperature Range	-30°F to +155°F

Features and Benefits

- Provides a safety solution for narrow edges
- Suit a wide variety of applications
- Easy installation
- Manufactured with durable materials
- High quality control standards

Applications

- Industrial safety
- Automatic door reverse
- Sliding door reverse
- Drive through window actuation

View the full product line at Larco.com

2011-0007-000 Rev. B 5/19



WARNING: Cancer and Reproductive Harm - www.P65Warnings.ca.gov

ATEK Access Technologies
10025 Valley View Road, Ste. 190
Eden Prairie, MN 55344 U.S.A.

PH: 1.800.523.6996
FAX: 1.800.589.3705
+1.218.829.9797

www.atekaccess.com



Access the power of technology.